

Schaulaterne DIN SS

cylinder sight glass
DIN welding ends

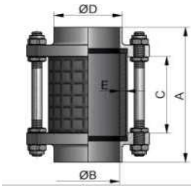

Art. 61300-								AISI 304/304L-1.4301/1.4307				AISI 316L-1.4404			
DN	A	B	C	D	E	Gew.		Art.-Nr.	Preis	Art.-Nr.	Preis	Art.-Nr.	Preis	Art.-Nr.	Preis
	mm	mm	mm	mm	mm	kg		bl. NBR	EUR	bl. NBR*	EUR	bl. NBR	EUR	bl. NBR*	EUR
10	92,0	10,0	60,0	14,0	2,5	0,250		-010120C	59,60	-0101203	73,65	-0103200	83,45	-0103203	97,50
15	92,0	16,0	60,0	20,0	2,5	0,300		-015120C	61,80	-0151203	76,15	-0153200	85,40	-0153203	99,75
20	92,0	20,0	60,0	24,0	3,0	0,730		-020120C	66,30	-0201203	83,15	-0203200	92,70	-0203203	109,55
25	98,0	26,0	70,0	30,0	3,0	0,750		-025120C	46,85	-0251203	64,00	-0253200	65,50	-0253203	82,65
32	104,0	32,0	70,0	36,0	3,0	0,760		-032120C	48,40	-0321203	65,95	-0323200	67,35	-0323203	84,90
40	112,0	38,0	70,0	42,0	5,0	1,080		-040120C	51,65	-0401203	71,95	-0403200	71,65	-0403203	91,95
50	112,0	50,0	70,0	54,0	5,0	1,340		-050120C	57,05	-0501203	78,05	-0503200	79,90	-0503203	100,90
65	127,0	66,0	85,0	70,0	5,0	1,900		-065120C	70,95	-0651203	98,35	-0653200	98,60	-0653203	126,00
80	135,0	81,0	85,0	85,0	5,0	2,350		-080120C	98,25	-0801203	129,00	-0803200	136,80	-0803203	167,55
100	169,0	100,0	115,0	104,0	5,0	2,800		-100120C	128,65	-1001203	165,7	-1003200	177,70	-1003203	214,75
125	202,0	125,0	160,0	129,0	7,0	6,350		-125120C	360,70	-1251203	413,25	-1203200	500,55	-1203203	553,10
150	216,0	150,0	170,0	154,0	9,0	7,110		-150120C	714,00	-1501203	785,55	-1503200	991,15	-1503200	1062,70

* und Splitterschutz

* and safety screen

Schaulaterne DIN KG

cylinder sight glass
DIN liner/male

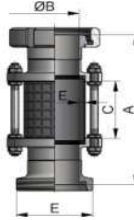

Art. 61500-								AISI 304/304L-1.4301/1.4307				AISI 316L-1.4404			
DN	A	B	C	D	E	Gew.		Art.-Nr.	Preis	Art.-Nr.	Preis	Art.-Nr.	Preis	Art.-Nr.	Preis
	mm	mm	mm	mm	mm	kg		bl. NBR	EUR	bl. NBR*	EUR	bl. NBR	EUR	bl. NBR*	EUR
10	122,0	10,0	60,0	2,5	Rd28x1/8	0,380		-010120C	87,75	-0101203	101,80	-0103200	115,40	-0103203	129,45
15	122,0	16,0	60,0	2,5	Rd34x1/8	0,450		-015120C	89,25	-0151203	103,60	-0153200	124,55	-0153203	138,90
20	124,0	20,0	60,0	3,0	Rd44x1/6	0,690		-020120C	96,85	-0201203	113,70	-0203200	134,90	-0203203	151,75
25	142,0	26,0	70,0	3,0	Rd52x1/6	1,020		-025120C	73,60	-0251203	90,75	-0253200	102,75	-0253203	119,90
32	154,0	32,0	70,0	3,0	Rd58x1/6	1,250		-032120C	80,15	-0321203	97,70	-0323200	112,05	-0323203	129,60
40	164,0	38,0	70,0	5,0	Rd65x1/6	1,670		-040120C	85,35	-0401203	105,65	-0403200	119,15	-0403203	139,45
50	168,0	50,0	70,0	5,0	Rd78x1/6	2,170		-050120C	93,60	-0501203	114,60	-0503200	131,95	-0503203	152,95
65	191,0	66,0	85,0	5,0	Rd95x1/6	3,260		-065120C	122,15	-0651203	149,55	-0653200	172,05	-0653203	199,45
80	209,0	81,0	85,0	5,0	Rd110x1/4	3,710		-080120C	169,60	-0801203	200,35	-0803200	236,65	-0803203	267,40
100	257,0	100,0	115,0	5,0	Rd130x1/4	5,100		-100120C	235,65	-1001203	272,70	-1003200	328,15	-1003203	365,20
125	270,0	125,0	160,0	7,0	Rd160x1/4	9,500		-125120C	548,55	-1251203	601,10	-1203200	764,30	-1203203	816,85
150	290,0	150,0	170,0	9,0	Rd190x1/4	11,300		-150120C	1023,35	-1501203	1094,90	-1503200	1424,05	-1503203	1495,60

* und Splitterschutz

* and safety screen

Schaulaterne Zoll SS

cylinder sight glass
(inch) welding ends

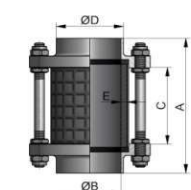

Art. 61301-								AISI 304/304L-1.4301/1.4307				AISI 316L-1.4404			
DN	A	B	C	D	E	Gew.		Art.-Nr.	Preis	Art.-Nr.	Preis	Art.-Nr.	Preis	Art.-Nr.	Preis
	mm	mm	mm	mm	mm	kg		bl. NBR	EUR	bl. NBR*	EUR	bl. NBR	EUR	bl. NBR*	EUR
1"	96,0	23,3	70,0	28,0	3	0,750		-100120C	47,30	-1001203	64,45	-1003200	66,15	-1003203	83,30
1,5"	110,0	35,1	70,0	41,0	5,0	1,080		-112120C	52,20	-1121203	72,50	-1123200	72,35	-1123203	92,65
2"	110,0	47,8	70,0	54,0	5,0	1,340		-200120C	57,60	-2001203	78,60	-2003200	80,70	-2003203	101,70
2,5"	125,0	60,5	85,0	68,0	5,0	1,900		-212120C	71,65	-2121203	99,05	-2123200	99,60	-2123203	127,00
3"	133,0	72,8	85,0	78,1	5,0	2,350		-300120C	99,25	-3001203	130,00	-3003200	138,15	-3003203	168,90
4"	167,0	97,6	115,0	103,6	5,0	2,800		-400120C	129,90	-4001203	166,95	-4003200	179,45	-4003203	216,50

* und Splitterschutz

* and safety screen

Glaszylinder

glas cylinder

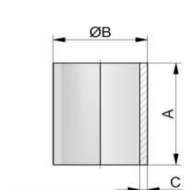

Art. 61700-							Borosilikat / borosilicate	
DN	A	B	C	D	E	Gew.	Art.-Nr.	Preis
	mm	mm	mm	mm	p (bar)	kg		EUR
10	60,0	15,0	2,5			28	-0100	4,65
15	60,0	22,0	2,5			18	-0150	4,65
20	60,0	26,0	3,0			18	-0200	4,65
25	70,0	32,0	3,0			14	-0250	5,55
32	70,0	40,0	3,0			11	-0320	5,55
40	70,0	50,0	5,0			15	-0400	7,15
50	70,0	60,0	5,0			12	-0500	9,50
65	85,0	75,0	5,0			10	-0650	12,00
80	85,0	90,0	5,0			8	-0800	14,75
100	115,0	110,0	5,0			6	-1000	29,75
125	160,0	140,0	7,0			7	-1250	62,15
150	170,0	170,0	9,0			7	-1500	126,25

p: max. Betriebsdruck

p: max. pressure